

W 61806-2RS1 Deep groove ball bearings

Deep groove ball bearings

Bearing data

[Tolerances](#),

Normal (metric), P6, P5, Normal (inch),

[Radial internal clearance](#),

Matched bearing pairs, Stainless steel
 $d < 10$ mm, Other bearings

Bearing interfaces

[Seat tolerances for standard conditions](#),

[Tolerances and resultant fits](#)

Technical specification

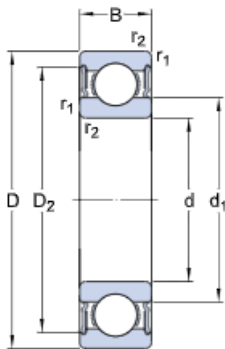

DIMENSIONS

| | | |
|-----------|--------------------|-------------------|
| d | 30 mm | Bore diameter |
| D | 42 mm | Outside diameter |
| B | 7 mm | Width |
| d_1 | ≈ 33.11 mm | Shoulder diameter |
| d_2 | ≈ 33.11 mm | Recess diameter |
| D_2 | ≈ 39.2 mm | Recess diameter |
| $r_{1,2}$ | min. 0.3 mm | Chamfer dimension |

ABUTMENT DIMENSIONS

| | | |
|------------------------|--------|-----------------------------------|
| d_{ε} min. | 32 mm | Diameter of shaft abutment |
| d_{ε} max. | 33 mm | Diameter of shaft abutment |
| D_i max. | 40 mm | Diameter of housing abutment |
| r_a max. | 0.3 mm | Radius of shaft or housing fillet |

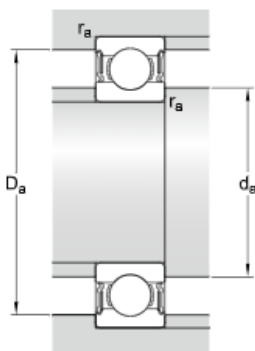

CALCULATION DATA

| | | |
|----------------|-------------|---------------------------|
| C | 3.58 kN | Basic dynamic load rating |
| C ₀ | 2.9 kN | Basic static load rating |
| P _u | 0.125 kN | Fatigue load limit |
| | 9 500 r/min | Limiting speed |
| k _r | 0.02 | Minimum load factor |
| f ₀ | 14.1 | Calculation factor |

MASS

| | | |
|--|----------|--------------|
| | 0.024 kg | Mass bearing |
|--|----------|--------------|

TOLERANCE CLASS

| | |
|--------|------------------------|
| Normal | Dimensional tolerances |
| Normal | Radial run-out |